

CHEFFINS



West Street, Ely, CB7 5RA

£975 PCM



Cambridge | Saffron Walden | Newmarket | Ely | Haverhill | London

- Minimum 12 Month Tenancy
- Sitting Room
- Modern Fitted Kitchen
- Bathroom
- Double Glazing
- Oil Fired Central Heating
- Parking
- One Bedroom Bungalow
- NO PETS

A beautifully presented one bedroom bungalow accessed via a private lane with parking to the front. The property comprises entrance hall, sitting room and modern fitted kitchen and bathroom. Further benefits include double glazing and oil fired central heating. Council tax band B. EPC Rating D.

Energy Efficiency Rating		
	Current	Potential
Very energy efficient - lower running costs		
(92 plus) A		
(81-91) B		89
(69-80) C		
(55-68) D	57	
(39-54) E		
(21-38) F		
(1-20) G		
Not energy efficient - higher running costs		
England & Wales		
EU Directive 2002/91/EC		

Council Tax Band – B
Local Authority – East Cambs

Ground Floor

Approx. 45.1 sq. metres (485.6 sq. feet)

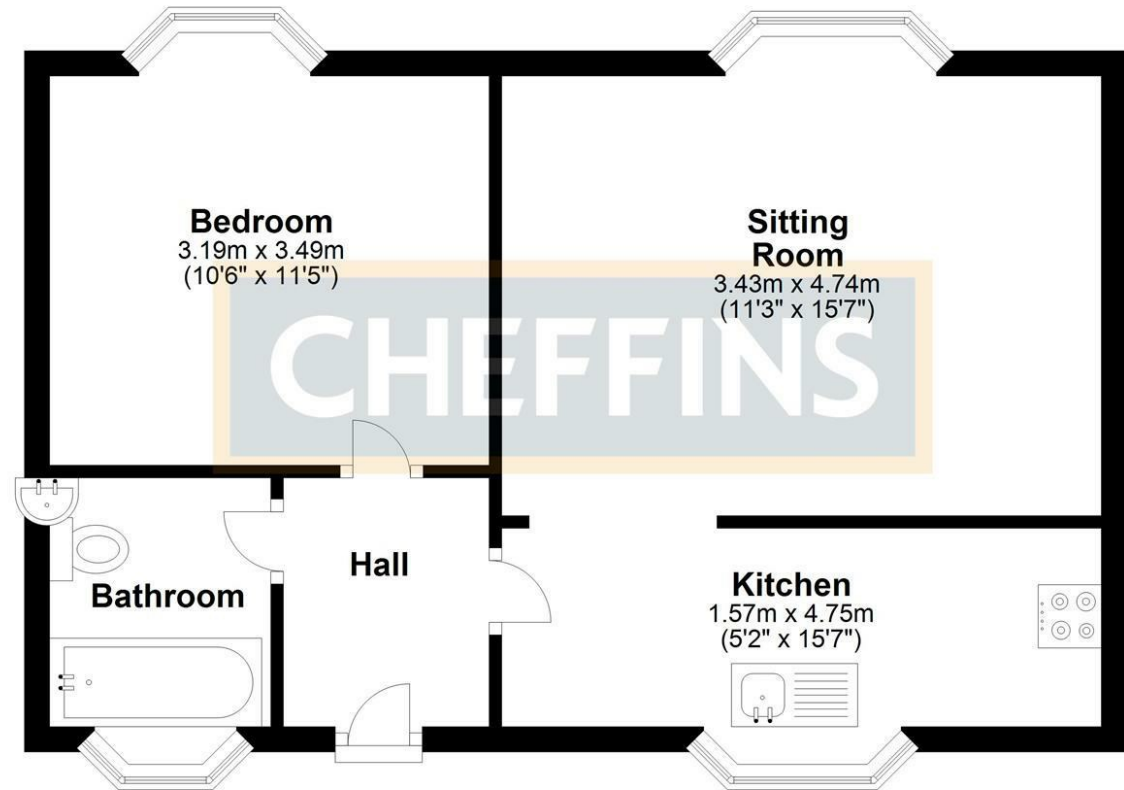

Total area: approx. 45.1 sq. metres (485.6 sq. feet)

Agents Note: Stamp Duty thresholds have and are changing imminently. Please familiarise yourself with the current thresholds and timescales before moving forward with any transactions.

More details can be found at: <https://www.gov.uk/stamp-duty-land-tax>.

For more information on this property please refer to the Material Information Brochure on our website.

2 Black Bear Court, Newmarket, Suffolk, CB8 9AF | 01638 663228 | cheffins.co.uk

IMPORTANT: we would like to inform prospective purchasers that these sales particulars have been prepared as a general guide only. A detailed survey has not been carried out, nor the services, appliances and fittings tested. Room sizes should not be relied upon for furnishing purposes and are approximate. If floor plans are included, they are for guidance only and illustration purposes only and may not be to scale. If there are any important matters likely to affect your decision to buy, please contact us before viewing the property.



CHEFFINS